

# SP80-C10-4P

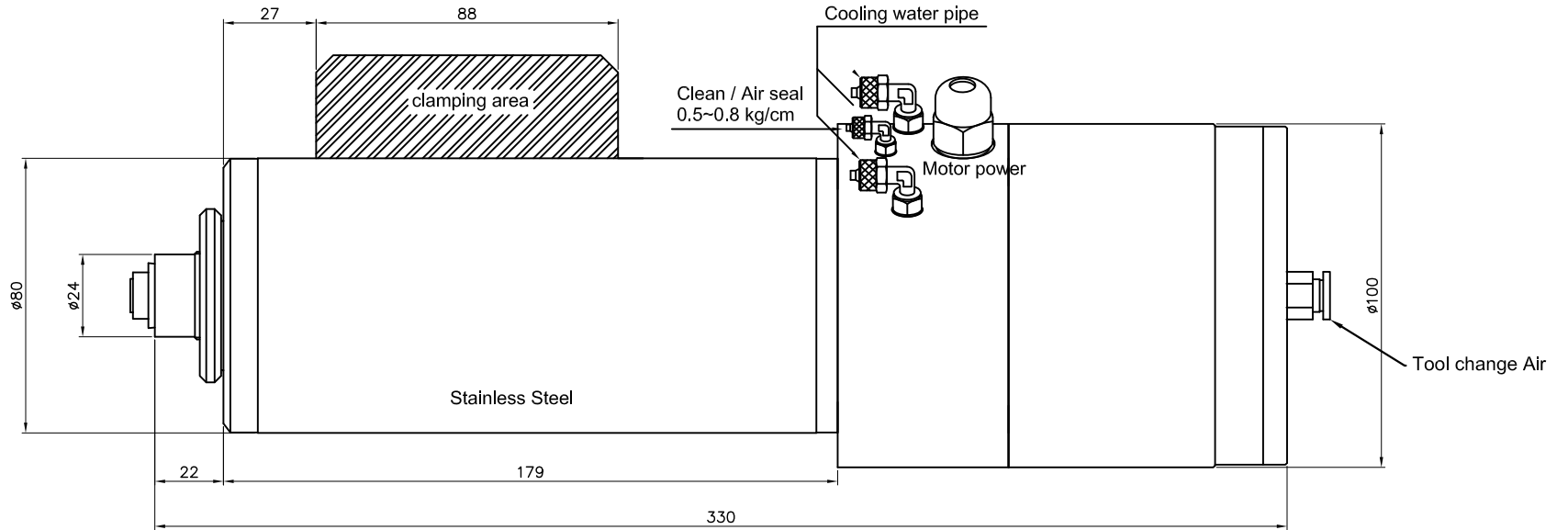

## COLLET

φ6.0mm, φ10mm

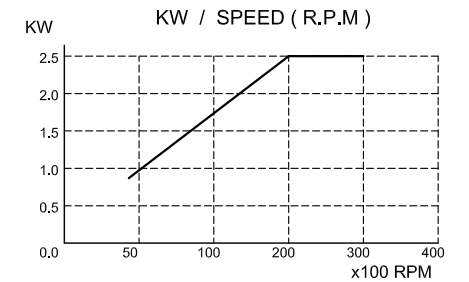
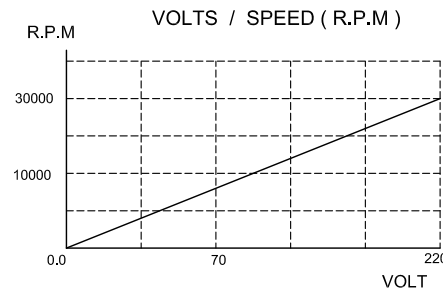
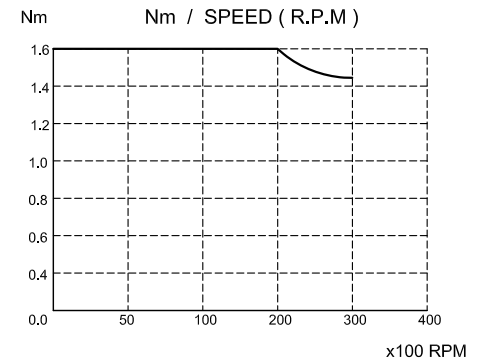
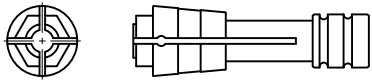

### Specification

### Data

|                                    |                        |
|------------------------------------|------------------------|
| Motor Type ( 馬達型式 )                | 220V . (4P) . 3φ       |
| Power Output ( 輸出功率 )              | 2.5 KW                 |
| Maximun Speed ( 最高轉速 )             | 1000~30000 R.P.M       |
| Maximun Dynamic Runout ( 偏擺精度 )    | 0.01 mm                |
| Cooling Type ( 冷卻方式 )              | Water                  |
| Collet Actuation Pressure ( 夾頭開合 ) | 7~8 kg/cm <sup>2</sup> |
| Body Size ( 外部尺寸 )                 | φ80mm                  |
| Weight ( 重量 )                      | 8.0 kg                 |